

**UCO BANK**  
**Zonal Office, Nagpur**

**‘FORWARDING LETTER**

Note: - Tender to be submitted on or before 5.00 PM on 27-10-2025.

To,

The Dy. Zonal Manager,  
Zonal office, UCO Bank,  
Nagpur Zone, Nagpur.

From

\_\_\_\_\_  
\_\_\_\_\_  
\_\_\_\_\_

**Sub: Tender for Interior & Electrical Furnishing Work of Chandrapur Branch, Dist.- Chandrapur,  
Under Nagpur Zone.**

Dear Sir,

With reference to the tender invited by you for above mentioned work, I / we hereby offer to execute the items of work specified in the Schedule – B. I / we have examined and studied carefully all the drawings, specifications, conditions of contract, site and agree to comply with them. I / we agree to complete the whole work within the stipulated time from the date of work order. I / we are aware that any of schedule - B items/s can be canceled or replaced and quantity of any of items can be increased or decreased at any time by the Architect OR Owner, for which I/ we shall not claim extra.

Name of partners, if any

(With certified Partnership Deed)

1. \_\_\_\_\_
2. \_\_\_\_\_
3. \_\_\_\_\_

Yours Faithfully

**Contractor's Signature**  
**(With Stamp & Address)**

**UCO BANK**  
**Zonal Office, Nagpur**

**NOTICE TO TENDERERS:**

1. Sealed tenders should be addressed to **Zonal Manager, Zonal office, UCO Bank, Nagpur** and super scribed as **“TENDER FOR Interior & Electrical Furnishing Work of Chandrapur Branch, Dist- Chandrapur, Nagpur Zone** and sent as to reach this office not later than **5.00 PM on 27-10-2025** Tender should be accompanied with **Earnest Money Deposit (EMD)** of **Rs. 20000=00 (Rupees Twenty Thousand Zero Hundred Only)** in the form of **Demand Draft in favor of UCO Bank, Nagpur**. Tenders not accompanied with EMD shall be rejected and considered invalid. The earnest money shall be returned to the tenderer if the tender is not accepted but without any interest. EMD amount deposited by the tenderer, whose tender is accepted, shall be adjusted towards security deposit to be retained by the Bank for one year.
2. No tender will be received after **5.00PM On 27<sup>TH</sup> October 2025**.
3. Tender will be opened at Zonal office **on 28-10-2025 at 5.00 PM** by the Zonal Manager or his nominee. **(Note:-The rates tendered by the contractors shall be valid for 90 days from the date of opening.)**
4. **Zonal Manager, Zonal office, UCO Bank, Nagpur Zone** does not bind himself to accept the lowest or any tender and reserves the right to accept or reject any or all the tenders whether in whole or in part without assigning any reason for doing so. The owner reserves his rights to negotiate with the lowest or any other tender/s.
5. Each of the tender documents is required to be signed by the person or persons submitting the tender in token of his/ their having acquired himself/ themselves with the general conditions, articles of agreement, mode of measurements, schedule of probable quantities, site conditions and the time schedule etc. as laid down. Any tender with any of the documents not signed will be liable to be rejected.
6. Tenderer shall fill in rates for all items of work described in the Schedule -B. All entries must be made by hand and in ink. **The rates quoted for the items shall compulsorily be in “Figure” & “Words” in English.** In the event of discrepancy between the rates quoted in figures & words, the rates quoted in words, shall be binding. Tender not quoted in above said manner will be refused and will not be considered. Items against which no rate is entered by the tenderer will not be paid for by the Owner when. Executed and shall be deemed covered by the other rates in the Schedule-B. If any of the documents is missing or unsigned the tender shall be considered invalid.
7. All erasures and alterations made while filling the tender must be attested with initials of the Tenderer. Overwriting of figures is not permitted. Failure to comply with either of these conditions will render the tender invalid.
8. All the pages of the tender documents should be signed by the tenderer.
9. Within Seven days of the receipt of intimation from the Owner of acceptance of his/ their tender, the successful tenderer shall be bound to implement the contract by signing the

**U C O   B A N K**  
**Z o n a l   O f f i c e ,   N a g p u r**

agreement in accordance with the draft agreement and the conditions of contract with the owner.

10. The security deposit shall be kept with the Owner for a period of 12 months after the Architect issues the completion certificate which amount is not to bear interest.
11. The rates quoted by the contractor should include all charges for scaffolding materials labour, hire for any tools, marking out and clearing of the site as mentioned in the specifications. The rate quoted by the tenderer in the Schedule-B of probable quantities will be deemed to be for the finished work to be measured at site. The rates shall be inclusive of all VAT, sales tax, octroi duty; works contract tax, Provident Fund, Insurance etc. levied by any Government or any public body. The contractor shall abide by the rules of Minimum Wage Act and Child Labor Act and keep the work as required under the workman compensation act, labor laws etc. as prevailing.
12. The rate shall be binding to the Contractor, for all the tender items till the completion of the work Irrespective of variation in market rates of material and labor.
13. The calculations made by the tenderer should be based upon probable quantities of the several items of work, which are furnished for the tenderers convenience in the schedule B. It must be clearly understood that the contract is not a lump-sum contract that neither the probable quantities nor value of the individual and the aggregate value of the entire tender will form a part of the contract and that Architect doesn't in any way assure the tenderer or guarantee that the said probable quantities are correct or that the work would correspond thereto.
14. The items against which no quantity is shown in schedule-B for which tenderer is to quote his rates and the Owner at his description shall ask the contractor to execute those items if required and which shall be binding on the part of the contractor to execute those items at the rates quoted therein in the tender.
15. Special attention of the tenderer is drawn to the alternative items in the schedule of probable quantities. The rates and amount for these alternative items shall be duly filled in. The Architect reserves to himself the right to adopt any of the alternative items, either after scrutinizing and deciding upon the tenders or later when the work is being executed.
16. The successful tenderer should make his/ her own arrangement to obtain all materials required for the work.
17. The various materials stored on site shall be protected from the fire, floods or rains etc. and the contractor shall be responsible for any damage caused to the owner for the same.
18. The contractor shall allow enough facilities to the sub-contractors employed by the owner and should co-operate with them and that small holes etc. made by these sub-contractors to the structure shall be properly corrected by the general contractor without any prejudice and extra cost whatsoever.
19. The bills shall be prepared by the contractor in the manner required by the Architect and should be submitted to him. The owner shall pay the contractor within the 15 days time from the issue of the certificate of payment by the architect. All payments by the owner under this contract shall be made at Nagpur.
20. The tender submitted on behalf of a firm shall be signed by all the partners/ directors of the firm or by a partner who has the necessary authority on behalf of the firm to enter into the proposed contract. Otherwise, the owner may reject the tender.
21. The specifications that are not mentioned or listed in the tender shall conform to I.S.I. Specifications while having prior written consent of the Architect.

**U C O   B A N K**  
**Z o n a l   O f f i c e ,   N a g p u r**

22. In case of dispute regarding quality of material, workmanship etc. shall be settled and accepted as final decision on the basis of test reports obtained from Visvesvaraya National Institute of Technology, Nagpur.
23. The contract shall be subject to Nagpur jurisdiction only.
24. The owner reserves the right to omit any item or items or part thereof for which contractor shall not claim any compensation whatsoever.
25. Contractor is advised to visit branch before submitting the tender to ascertain the required civil related work.
26. Contractor must inform in writing to the Architect before executing any work that is not covered in Tender or any quantities of the tendered item that is increasing while executing the work. Prior permission from the Owner shall be obtained before executing any such item.
27. The Architects for this work is **M/s. Shreyash Nandanwar & Co., 104, Nirmala Apartment, Amravati road, Tilak Nagar, Nagpur-440010**

I/ We hereby declare that I/We have read and understood the above instructions for the guidance of the

Tenderer.

Date:

Seal

**Signature of the Tenderer**

**(SEAL)**

---

Space for office use:

**U C O   B A N K**  
**Z o n a l   O f f i c e ,   N a g p u r**

**APPENDIX HERE IN BEFORE REFERRED TO:**

**Name of Work: Interior & Electrical Furnishing Work of Chandrapur Branch, Dist-  
CHANDRAPUR, Nagpur Zone office.**

1. Defects Liability Period : One year from the date of virtual completion.
2. Period of Final Measurement and Valuation : 30 days from the date of virtual completion.
3. Date of Commencement : Within 4 (Four) days from issue of Work Order
4. Period of completion : 45 (Forty-Five) Calendar days.
5. Agreed Liquidated Damages -- : Rs.1000=00 per day.
6. Value of Work for Interim Certificate : On completion.
7. Retention Percentage of each Running Bill. : 5 %
8. Rate of Interest for Delayed Payment : Nil

---

**Space for Office Use**

**UCO BANK**  
**Zonal Office, Nagpur**

**LIST OF APPROVED MATERIALS FOR INTERIOR & ELECTRICAL WORK: -**

**NOTE:**

1. **No deviation permissible.**
2. Wherever Contractor proposes **to use 'equivalent'** makes (i.e. other than specified) the same shall be done only after prior approval from Architect. Any additional expenditure time due to this will be on Contractor's account and no claims will be entertained.
3. All materials to be used shall be of first quality unless otherwise specified and as prescribed in Banks Standard Manual.
4. Contractor shall produce proof of purchase and use of the approved material as prescribed by the Architect, from the company/ manufacturer at the time of presenting running bill and the final bill.

S.NO.	ITEMS	MAKE
<b>FOR INTERIOR WORK</b>		
1	Plywood	Green Ply, Century Ply, Kit Ply or as directed by Architect. (Note:- No Substitute Like Sainik / Ecotec or Associate Ply is to be used or as per Directed by Architect).
2	Laminates	Merino Lam, Green Lam, Century Lam or as directed by Architect.
	Steamed Anegre (equivalent to 366 of M/s Century	This colour will be provided on table top and façade of counters & partitions in strips
	Sugar Maple (equivalent to F1-1758 of M/s Formica)	This colour will be provided at vertical faces of all counter / partitions along with façade of the counter / tables.
	Goncalo Alvez (equivalent to 1769 of M/s Sunmica)	This colour will be provided at skirting.
3	Glass	Modiguard, Saint-Gobain.
4	Door Closer / Floor Springs	Ozone, Dorma.
5	Vertical Blinds	Vista or as directed by Architect.
6	False Ceiling board & frame	Indian Gypsum (Saint Gobain) only.
7	Locks & all accessories	Godrej, Acme, Ebco, Ozone.
<b>FOR ELECTRICAL WORK</b>		

**UCO BANK**  
**Zonal Office, Nagpur**

1	Wires	Poly Cab, RR, HPL or as directed by Architect.
2	Cables	Polycab, V-Guard, HPL or as directed by Architect
3	6A Switches & Sockets	Anchor Roma or as directed by Architect.
4	Ceiling Roses, Holders, Buzzers, Bell Push, Bell.	Anchor Roma or as directed by Architect.
5	MCB's & DB accessories.	L & T, Siemens, MDS or as directed by Architect.
6	Interior & Electrical fittings	WIPRO or as directed by Architect.
7	Fans	Crompton / Bajaj- (High speed models) or as directed by Architect.
8	HRC switch fuse unit	E.E, L & T, Siemens.
9	Bus- Bar Chamber	Standard / Ashoka
10	Cable glands & lugs	Siemens Dowels.
11	15A Switch Socket	Anchor Roma or as directed by Architect
12	16A DP switches with Fuse	Anchor Roma or as directed by Architect
13	Telephone Wires	Poly Cab, RR or as directed by Architect
14	Fluorescent Tubes, Bulbs	WIPRO, Osram or as directed by Architect
15	Electronic Regulators	Anchor Roma or as directed by Architect
16	PVC conduits	Precision, Diamond or as directed by Architect
17	Casing capping & Accessories	Precision, Modi or as directed by Architect
18	G.I. "B" class pipe	Prakas, Surya or as directed by Architect.

**Name of Work: - Interior Furniture Work of Chandrapur Branch, UCO Bank, Zonal Office, Nagpur.**

SR. NO	DESCRIPTIONS	UNITS	QTY.	RATE (Rs.)	AMOUNT (Rs.)
--------	--------------	-------	------	------------	--------------

Tender –Interior Furniture & Electrical Work of Chandrapur Branch, Chandrapur, Zonal Office-Nagpur.

**Architect: - M/s Shreyash Nandanwar & Co.**

**UCO BANK**  
**Zonal Office, Nagpur**

PART-A INTERIOR WORK (For Bank & ATM Block)					
1.	<b>FALSE CEILING (ARMSTRONG):-</b> Providing & fixing in position false ceiling in Armstrong 600X 600 mm X 15/16 mm Dune Supreme RH 99 Prima tile with Tegular edge framework as specified by Armstrong Co. with suspenders wherever required. Making necessary framework for A.C. ducting, if any, and necessary cutouts for diffusers and light fittings, taping and finishing to proper line & level, including making grooves and trap doors for A.C.unit in 18mm thick M.R.Grade Plywood with Stainless Steel hinges & locks with moulding 1" x 1" for edges including finishing with White Plastic Emulsion Paint etc. complete in all respects.(Note:- Only the Plain area will be measured for payment. No extra payment will be made for cutouts, grooves, moldings etc. Quantity mention including ATM Area Block.)	Sq.ft.	816.00		
a.					
b.	<b>FALSE CEILING (POP/Gyp. BOARD) :-</b> Providing and fixing false ceiling of 12mm th. Of fibrous plaster of paris or Gypsum Board which includes G.I. Perimeter channel (MF6) of size 0.40mm th. (having one flange of 20mm and another flange of 30mm and web of 27mm) along with perimeter of ceiling, screw fixed to brick wall, concrete surface, partition with the help of nylon sleeves and screws at 610mm centers. Thereafter suspending G.I intermediate channel (MF7) 600mm. c/c of size 45mm (0.9mm th.with two flanges of 15mm each) from the soffit at 450mm center with connecting angle (i.e ceiling angle) of width 25mm x 10mm x 0.40mm th. Fixed to soffit with G.I. cleat and teel expansion fasteners. Ceiling sections (MF5) of 0.55mm th.having knurled web of 51.5 mm and two flanges of 26mm each with lips of 10.5 mm are then fixed to the intermediate channel with the help of connecting clip and in direction perpendicular to the intermediate channel at 450mm centers. 12.5mm tapered edge is then screw fixed to ceiling section with drywall screws at 230mm centers. Screws fixing is to be done mechanically with suitable attachment. The boards are to be joined and finished so as to have flush look which includes filling and finishing the tapered & square edges of the boards with jointing compound, joint paper tape and two coats of drywall top coat suitable for gypboard. The items includes for light	Sq.Ft	1770.00		



**UCO BANK**  
**Zonal Office, Nagpur**

	fitting, grill diffusers and cut out etc.have to made with frame of perimeter channels of size 20mm x 30mm x 0.55mm.th. supported suitable and angle bead is to be used at steps to get straight line finish etc. complete without any extra cost. Angle beads, control joints etc are to be used without any extra cost wherever required at site and directed by architect. providing and fixing handcast 1 <sup>st</sup> grade POP moulding of size 75mm to 150mm deep at the junction of the Gypboard ceiling and wall, column, beam etc with necessary filing on the back side including finishing as per drawing and as directed by architect. Applying acrylic Emulsion (Dulux ICI paints) of approved make, shade and colour of 3 or more coats to the satisfaction of architect. The false ceiling is considered only in ATM Block. <b>(Note:- i)Regular single layer; Code: Gs-MFSc-4, manufactured by India Gypsum to be used .ii) No extra payment will be done for designs of any width and any length, which are made out of gypsum board). Rates includes making necessary cutouts / opening for light fittings, A.C. diffusers etc.</b>				
2.	<b>PARTLY GLAZED PARTLY PANEL FULL HEIGHT PARTITION:</b> - Providing and fixing partly glazed and partly panel full height partition is and where required or as directed by Bank/Architect's design/drawing made out of framework in Aluminum Section 50mm x 50mm x 1mm of 600 x 400mm c/c covered with 12mm th. plywood of approved make as specified i.e. Century Ply (i.e. Architect Ply, Club Prime, Bond-710), Green Ply (i.e. Green Gold, Green-700, Green Club-500) on both sides of the partition over which 1mm tk. laminate with approved make, color, shade (Century Lam / Greenlam / Sunmica / Archid Lam) is to be used. 6mm th. Clear float glass with appropriate design & pattern or as directed by Bank/Architect fixed with T.W moulded beading finished with wooden polish of approved shade and as directed by the Architect. The thickness of the partition will be 75mm (i.e 3" overall. <b>(Note: - Partition should be carry upto slab with required grouting in wall / slab soffit. Measurement up to false ceiling only will be paid, if provided in the branch premises.)</b>	Sq.ft	294.00		

**UCO BANK**  
**Zonal Office, Nagpur**

3.	<b>PARTLY GLAZED PARTLY PANEL LOW / MEDIUM HEIGHT PARTITION:</b> - Providing & fixing partly glazed partly panel low/medium height partition is and where required as per design & drawing or as directed by Bank/Architect made out of framework in Aluminum Section 50mm x 50mm x 1mm of 600 x 400mm c/c covered with 12mm th. plywood of approved make as specified i.e. Century Ply (i.e. Architect Ply, Club Prime, Bond-710), Green Ply (i.e.Green Gold, Green-700, Green Club-500) on both sides of the partition over which 1mm tk. laminate with approved make, colour, shade (Century Lam / Greenlam / Sunmica / Archid Lam) is to be used. The glazed portion shall be 10mm th. Clear float glass fixed with T.W moulding beading of required size on inner side of the partition finished with wooden polish of approved shade and as directed by the Architect. The thickness of the partition will be 75mm.	Sq.ft	48.00		
4.	<b>PARTLY GLAZED CASH CABIN SIDE &amp; BACK PARTITION:</b> - Providing & fixing partly glazed partly panel cash cabin side & back partition with 12mm Plywood of approved make i.e. Century Ply (i.e. Architect Ply, Club Prime, Bond-710), Green Ply (i.e.Green Gold, Green-700, Green Club-500) to either side of framework in Aluminum Section 50mm x 50mm x 1mm of 600 x 400mm c/c in both the direction as per design & drawing including 1mm thk. Laminate of approved shade and make (Century Lam / Greenlam / Sunmica / Archid Lam) up to the height of 4'0" from floor. Power coated Al.Grill (Deco grill/202) in approved shade,design & colour shall be provided above 4'0" up to required height (i.e 3'0" appr.) fixed with T.W/ Al.beading of req. size on both sides with provision of tray 9" x 12" of size in the cash cabin as per drawing and design and as directed by Architect. Exposed faces of Plywood & T.W beading shall be finished with wooden polish of approved shade or as directed by the architect.	Sq.ft	123..00		
5.	<b>ENTRANCE DOOR WITH FULLY GLAZED WOODEN PARTITION (FOR BRANCH &amp; ATM):-</b> Providing and fixing glazed door of Entrance door with fully glazed 18mm th. plywood partition at Entrance as per design & drawing or as directed by Architect made out of standard outer frame of 100mm x 44mm x 1.5mm th. , vertical styles of 83mm x 45mm x 1.5mm th., bottom 144mm x 44mm x 1.5mm with	Sq.ft	28.5		

**UCO BANK**  
**Zonal Office, Nagpur**

	5/10mm th. float toughen glass (Modi/Asahi/Saint Gobain float) for door shutter and fixed partition with necessary etching work, beveling etc. complete fixed on floor spring of Ozone/Ozone/Godrej make (ISI mark, heavy duty, items taken separately). The shutters shall have proper fitting & fixture with SS handle on both side with proper night latch of Godrej make / mortise lock, Aluminum/SS Tower Bolt of 150mm long of approved make, Al.Door stopper etc. complete with erection, fixing finishing etc. and as directed by Architect.(Note :- Rate including fixed glass door with etching, polishing etc. complete. Or as per the direction of Bank/Architect)				
6.	<b>BRANCH MANAGER TABLE:</b> - Providing & fixing Branch Manager Table of size <b>5'6" x 2'8" x 2'6"</b> out of 18mm thk. plywood of approved make i.e. Century Ply (i.e. Architect Ply, Club Prime, Bond-710), Green Ply (i.e.Green Gold, Green-700, Green Club-500) for complete structure, drawers fixed with telescopic sliding channels, brush finished stainless steel handles for drawers & shutters, having CPU trolley, one key board tray and sliding writing top arrangement with mouse-pad (all Ebco make) & fixed to table-top from below 18mm thk. plywood shall be used for supporters, front modesty panel & footrest all having 1mm thk.laminate of approved shade and make (Century Lam / Greenlam / Sunmica / Archid Lam) (in multi colors & grooves) and 0.80mm thk. Laminate on all internal surfaces. Brush finished S.S handles of approved make and shade, locks & magnet for drawers, shutters, cable guards including T.W beading to all edges of ply, three coats of French polish of approved shade to all exposed T.W members with finishing etc. complete. (Item also includes 12mm thk. Plain glass over table top with beveled edges & wire manager hole.)	R.Ft	6.00		
7.	<b>BRANCH MANAGER SIDE TABLE:</b> - Providing & fixing Branch Manager Side Table as per site or (Size <b>3'0" x 1'6" x 2'6"</b> ) out of 18mm thk. Plywood of approved make i.e. Century Ply (i.e. Architect Ply, Club Prime, Bond-710), Green Ply (i.e.Green Gold, Green-700, Green Club-500) for complete structure & for support, table top with 6mm thk. Approved plywood back with 12mm thk. plywood sliding shutters, 1mm thk. laminates (Century Lam / Greenlam / Sunmica / Archid Lam) on external surfaces and 1.0mm thk.	R.Ft	3.50		

**UCO BANK**  
**Zonal Office, Nagpur**

	laminate on internal surface of approved shade (in multi colours), approved quality S.S handles, locking arrangement including T.W beading to all edges of ply with three coats of French polish of approved shade to exposed T.W members as per drawing and specifications.				
8.	<b>OFFICER TABLE:</b> - Providing & fixing Officer Table as per site or Drawing or approximately size <b>(4'9" x 2'6" x 2'6")</b> out of 18mm thk. Plywood of approved make i.e. Century Ply (i.e. Architect Ply, Club Prime, Bond-710), Green Ply (i.e.Green Gold, Green-700, Green Club-500) for drawers fixed with telescopic sliding channels, brush finished stainless steel handles for drawers & shutters, having CPU trolley, key boards tray with mouse pad (all Ebco make) & fixed to table top from below 18mm thk. plywood shall be used for supports, front modesty panel & footrest, all having 1mm thk. laminates (Century Lam / Greenlam / Sunmica / Archid Lam) of approved shade (in multi colours & grooves) and make and 1.0mm thk laminate on all internal surfaces. Brush finished S.S handles of approved make and shade, locks & magnet for drawers, shutters, cable guard including T.W beading to all edges of ply, three coats of French polish of approved shade to all edges of ply, three coats of French polish of approved shade to all other ply surfaces as per specifications with finishing etc. complete.	R.Ft	30.00		
9.	<b>OFFICER SIDE TABLE :-</b> Providing & fixing Officer Side table approximately size <b>(3'0" x 1'6" x 2'6") x 2 nos</b> out of 18mm th.plywood of approved make i.e. (Century Ply (i.e. Architect Ply, Club Prime, Bond-710), Green Ply (i.e.Green Gold, Green-700, Green Club-500) for supports and table top with 12mm th. plywood back with opening shutters, 1mm th.laminates (Century Lam / Greenlam / Sunmica / Archid Lam) on exposed faces & 0.8 mm on all internal surfaces of approved quality, SS handles, locking arrangement including T.W beading to all edges of ply with three coats of French polish of approved shade to exposed T.W beading, one coat of wooden primer and two coats of oil painting to all other ply surfaces as per drawing and specifications.	R.Ft	9.00		
10.	<b>CLERK / DAFTERY TABLE:</b> - Providing & fixing Clerk / Daftery Table as per site or Drawing or approximately size <b>(7'0" x 2'0" x 2'6") x 1nos</b> out of 18mm thk. plywood of approved make i.e Century Ply (i.e. Architect Ply, Club Prime, Bond-710),	R.Ft	4.00		

**UCO BANK**  
**Zonal Office, Nagpur**

	Green Ply (i.e.Green Gold, Green-700, Green Club-500) for drawers fixed with telescopic sliding channels, brush finished stainless steel handles for drawers & shutters, having CPU trolley, key boards tray with mouse pad (all Ebco make) & fixed to table top from below 18mm thk. Plywood shall be used for supports, front modesty panel & footrest, all having 1mm thk. laminates (Century Lam / Greenlam / Sunmica / Archid Lam) of approved shade (in multi colours & grooves) and make and 0.80mm thk laminate on all internal surfaces. Brush finished S.S handles of approved make and shade, locks & magnet for drawers, shutters, cable guard including T.W beading to all edges of ply, three coats of French polish of approved shade to all edges of ply, three coats of French polish of approved shade to all other ply surfaces as per specifications with finishing etc. complete.				
11.	<b>CLERK / DAFTERY SIDE TABLE:</b> - Providing & fixing Clerk Side table approximately size (0'0" x 0'0" x 0'0") x 0 nos out of 18mm th. plywood of approved make i.e. (Century Ply (i.e. Architect Ply, Club Prime, Bond-710), Green Ply (i.e.Green Gold, Green-700, Green Club-500) for supports and table top with 8mm th. plywood back with opening shutters, 1mm th.laminates (Century Lam / Greenlam / Sunmica / Archid Lam) on exposed faces & 0.8 mm on all internal surfaces of approved quality, SS handles, locking arrangement including T.W beading to all edges of ply with three coats of French polish of approved shade to exposed T.W beading, one coat of wooden primer and two coats of oil painting to all other ply surfaces as per drawing and specifications.	R.Ft	0.00		
12.	<b>DOOR CLOSER:</b> - Providing & Fixing Ozone/ Godrej heavy duty make door closer to doors, inclusive of fixing, finishing etc. complete.	No.	6.00		
13.	<b>FLOOR SPRING:</b> - Providing & fixing Ozone / Ozone / Godrej of heavy duty make only of ISI mark floor spring to doors only.	No.	2.00		

**UCO BANK**  
**Zonal Office, Nagpur**

14.	<b>WICKED GATE:</b> - Providing & fixing wicked gate with 18mm thk. Plywood of approved make i.e. (Century Ply (i.e. Architect Ply, Club Prime, Bond-710), Green Ply (i.e.Green Gold, Green-700, Green Club-500) to either side of the made out of framework in Aluminum Section 50mm x 50mm x 1mm of 600 x 400mm c/c covered with 12mm th. plywood of approved make as specified i.e. Century Ply (i.e. Architect Ply, Club Prime, Bond-710), Green Ply (i.e. Green Gold, Green-700, Green Club-500) including 1mm thk. Laminate of approved shade and make (Century Lam / Greenlam / Sunmica / Archid Lam) in multi colors and three coats of French polish of approved shade to all T.W members with necessary hinges etc. complete.Brass hinges 75mm long, Brass Tower Bolt 4" long and handles 4" long shall be painted / polished of desired shade as per designed specification.	Sq.ft	0.00		
15.	<b>SINGLE WINDOW COUNTERS (SWO):-</b> Providing & fixing single window counters (1nos) out of 18mm tk. plywood of approved make i.e. (Century Ply (i.e. Architect Ply, Club Prime, Bond-710), Green Ply (i.e.Green Gold, Green-700, Green Club-500) for officers of various size as per design & drawing or as directed by Architect with 3 no.s of working top & one key board arrangement with drawer unit in each cabin ,fixed with telescopic sliding channels, brush finished stainless steel handles for drawers & shutters, having CPU trolley, key board tray with mouse pad (all Ebco make) & cable guard. Counter front, working table top shall be provided with 1mm tk. laminate (Century Lam / Greenlam / Sunmica / Archid Lam)) outside & 0.80mm tk. laminate inside of approved shade (in multi colours) and make. As per design & drawing, 10mm th. Vertical glass in front face over counter top of required height with necessary etching & edges polishing as per design & drawing and as directed by Architect. The bottom of the drawer shall be finished with three coats French polish of approved shade to all T.W members and beading etc. complete.	R.Ft	5.50		

**UCO BANK**  
**Zonal Office, Nagpur**

16.	<b>CASH CABIN COUNTERS :-</b> Providing & fixing Cash cabin front counter as per design & drawing with total height of 4'0" out of which the ht. of working top is upto 2'6" and the upper partition with 1'6" in ht. from working top and glass top of required width and as per detailed drawing and directed by an Architect. The cash cabin is made out of 18mm tk. plywood of approved make i.e. (Century Ply (i.e. Architect Ply, Club Prime, Bond-710), Green Ply (i.e.Green Gold, Green-700, Green Club-500)and finished with 1mm.th. laminate sheet (Century Lam / Greenlam / Sunmica / Archid Lam)) as per design & drawing and of approved shade as directed by an Architect including T.W moulding abd design for exposed edge of counters at top. Drawers below table top shall be provided including fitting, fixtures Godrej locks (concealed) to all drawers, power coated handles, Ebco drawers, sliders (Telescopic) etc.complete. one sliding keyboard of req.size shall be provided with locking arrangement. Exposed portion shall be finished with French polish in three coats with finishing, carting, erection etc.complete.	R.ft	5.50		
17.	<b>CABIN DOORS / DOORS :-</b> Providing & fixing partly glazed partly paneled doors to toilet looby area near toilet, record room, Strong Room partition & near UPS room or as directed by an Architect as per design & drawing which is made in a Al.Section frame work of 75mm x 35mm @ 375mm c/c both ways with 8mm th. plywood of approved make i.e. Century Ply (i.e. Architect Ply, Club Prime, Bond-710), Green Ply (i.e.Green Gold, Green-700, Green Club-500)and finished with 1mm.th. laminate sheet (Century Lam / Greenlam / Sunmica / Archid Lam)) on both sides & finished with 1mm th. laminate of approved make, shade ie. (Century Lam / Greenlam / Sunmica / Archid Lam)) or as directed by an Architect. The upper portion of the shutter shall have 6mm th. clear glass panel @ 3'0" ht. from floor lvl. With necessary etching and with T.W beading of size 25mm x 12mm. The shutter have necessary hardwares which includes brass hinges, Night latch of godrej make / mortise lock / Aldrops as per req. brass tower bolt 150mm long, brass handle 100mm, door stopper with erection, finishing etc. complete and as directed by an Architect	Sq.Ft	138.00		

**UCO BANK**  
**Zonal Office, Nagpur**

18.	<b>PARTITION OVER CASH CABIN (FRONT PORTITION):-</b> Providing & fixing 10mm th. glass with necessary etching & edge polishing where ever required on cash counters of ht. app. 100mm with necessary T.W moulding beading of size 25mm x 25mm on both sides & T.W Patta / paneled partition at top, having an opening slit above the ht. of 300mm as per design & drawing and as directed by an Architect. The glass is to be properly grinded and edge polished wherever the edges are exposed. For panel partition up to required height made out of Aluminum Section member of framework of size 40mm x 40mm @ 400 c/c covered with 8mm th. Plywood of approved make i.e. Century Ply (i.e. Architect Ply, Club Prime, Bond-710), Green Ply (i.e.Green Gold, Green-700, Green Club-500) on both sides and finished with 1mm.th. laminate sheet (Century Lam / Greenlam / Sunmica / Archid Lam) in multi colours on both sides. Brass hinges 75mm long, Brass Tower bolt 100mm long and handles 100mm long shall be provided and all exposed edges shall be painted / polished of desired shade as per design and specification. The overall thickness of the partition with wicker door shall be 50mm.	Sq.Ft	33.00		
19.	<b>WRITING DESK with CHEQUE DROP BOX:-</b> Providing & fixing Writing Desk & Cheque Drop Box as per drawing put of 18mm th. plywood of approved make i.e. Century Ply (i.e. Architect Ply, Club Prime, Bond-710), Green Ply (i.e.Green Gold, Green-700, Green Club-500)and finished with 1mm.th. laminate sheet (Century Lam / Greenlam / Sunmica / Archid Lam)) and finished with 1mm th.laminate of approved make, shade ie. (Century Lam / Greenlam / Sunmica / Archid Lam)) and 10mm th. glass to be fixed into frame for keeping voucher etc. as per drawing and as directed by Architect.	No.	1.00		
20.	<b>GRANITE TOP :-</b> Providing & fixing Granite Top over Counter table and Cash Cabin of 0.30m width in Cash Cabins and 0.20m width in SWO/CTO counter in the waiting / public area fixed over plywood table working top and Granite cladding on the front wall with araldite / epoxy materials (resin + hardeners) including full round moulding, fixing, finishing etc. complete.	Sq.ft	11.00		
21.	<b>FULL HEIGHT STORAGE / LOW HEIGHT STORAGE / BACK STORAGE (CREDENZA) :-</b> Providing and fixing in position Full height Storage/Low	Sq.Ft	726.00		



**UCO BANK**  
**Zonal Office, Nagpur**

	height Storage/Back Storage (Credenza) as per specified dwg.by using plywood of required thickness finished with 1mm thick laminates as shown in the specified dwg. and all other sides shall be finished with white enamel paint as detailed therein. The Storage units shall be provided with handles (Stainless Steel finish) as per approval of the Project Consultant/Bank. All exposed plywood surfaces to be finished with 1mm tk.laminate of approved make & shade all exposed edges of plywood to wave 1" x ¼" T.W. lipping. All exposed T.W. sections to be melamine in internal surfaces to have white enamel paint as directed. Item to include all necessary hardware and fittings in Stainless Steel finish, Godrej multipurpose locks including magnetic ball catcher etc.complete in all respect.				
22.	<b>VENATION BLINDS / VERTICAL BLINDS:-</b> Providing & fixing as per approved make (Vista levolor / Aerolux) 100mm wide vertical blinds complete with handling chain, sliding & tilting system in drawn position, fabric vanes to overlap by minimum 10mm(every 1m.length to have at least 12nos.100mm wide fabric-vanes). Length of blinds bottom end to be at least 12mm from horizontal surface fabric strip as that of fabric vanes, to be fixed on both sides on aluminum top channel. Lower end of vanes to be weighed down & tight with each other on both corners with ball chains. Items to be completed in all respects including fixing with brackets on wall or partition with rawl plugs.	Sq.ft.	294.00		
23.	<b>COLUMN CLADDING:-</b> Providing & fixing paneling over RCC column or wherever required as per directed by Architect/Bank with 12mm th. Plywood of approved make i.e. Century Ply (i.e. Architect Ply, Club Prime, Bond-710), Green Ply (i.e.Green Gold, Green-700, Green Club-500) on aluminum frame work 2" x 1" at 12"c/c on both side finished with 1mm th. Laminate of approved colour & make (Century Lam / Greenlam / Sunmica / Archid Lam)). The rate shall include all necessary hardware fittings etc. The rates shall include work in multicolour laminates, grooves. All necessary	Sq.Ft.	600.00		

**UCO BANK**  
**Zonal Office, Nagpur**

	hardware, tools and plants required for the work to make to the column/wall in true line & level. (Cladding till ceiling level).				
24.	<b>M.S GRILL PARTITION WITH CHANNEL GATE:-</b> Providing and fixing M.S Grill Partition with channel gate in one / two leaves with channel pickets, pivoted flat bars, including top and bottom guides, rollers, stoppers, handles, all fitting accessories, locking arrangement and one coat of red lead primer etc. complete.(For Strong Room covering safe area and at required position or as directed by an architect.)	Sq.Ft	0.00		
25.	<b>STAINLESS STEEL 3-SEATER CHAIR:-</b> Providing and supplying Perforated Stainless Steel coated sitting arrangement or kind of Airport chairs or 3-Seater Steel Chairs in waiting area for customers or as per site condition with arms/Legs of Die cast top quality 304 material stainless steel after polish with powder coating. Side Casting made from top quality 201 material stainless steel after bend, typing and polishing with powder coating. Seat made from top quality 201 material stainless steel after precise and draw bench with powder coating. Beam of the chair is made from top quality steel after precise pressing and welding with powder coating etc. and placing on site or as per the direction of Architect/Bank with back perforated steel work with Stainless Steel hand rest of approved colored or shade or as per the direction of Bank/Architect. (Make of Featherlite Stainless Steel Company only. No Chromium Plated material is to be used.)	No.  For  5 - Seater Sofas	4.00		
26.	<b>FULL HEIGHT SOLID WOODEN T.W. PARTITION: -</b> Providing and fixing full height Solid Wooden T.W. Partition is and where required or as directed by Bank/Architect's design/drawing made out of framework in Aluminum section 50mm x 50mm x 1mm of 600 x 400mm c/c covered with 12mm th. plywood of approved make as specified i.e. Century Ply (i.e. Architect Ply, Club Prime, Bond-710), Green Ply on both sides of the partition over which 1mm tk. laminate with approved make, colour, shade (Century Lam / Greenlam / Sunmica / Archid Lam) is to be used. 6mm th. Clear float glass with appropriate design & pattern or as directed by Bank/Architect fixed with T.W moulded beading finished with wooden polish of approved shade and as directed by the Architect. The thickness of the partition will be 50mm (i.e 2" overall).(Note: - Partition should be carry	Sq.ft	195.00		

**UCO BANK**  
**Zonal Office, Nagpur**

	upto slab with required grouting in wall / slab soffit. Measurement up to false ceiling only will be paid, if provided in the branch premises.)				
27.	<b>NOTICE BOARDS:-</b> Providing & fixing lockable notice boards 3'0" x 2'6"size x 2" deep, made up of soft board fully covered by approved colour upholstery & fixed on 12mm approved ply backing & wide double-leaf shutters out of 18mm th. Approved ply having cutout for 4mm th.clear glass fixed with required size T.W beading including three coats of French polish of approved shade to T.W beading and necessary hinges, fixtures & fastenings etc.complete.	No.	2.00		
28.	<b>SIDE TABLE / CENTER TABLE:-</b> Providing Side Table of size 2'0" x 2'6" x 1'6" and Center Table of size 3'0" x 2'0" x 1'6" in teak wood structure as per drawing & design with three coats of French polish of approved shade and 12mm th. Clear glass top with beveled edges, fixed with vacuum fixers etc. complete or as directed by Bank / Architect in charge. (Note: To be done only prior information of bank/architect or as directed by Authority.)	No.	1.00		
29.	<b>SUGGESTION BOX / COMPLAINT BOX:-</b> Providing & fixing 18" x 18" x 6" deep Suggestion Box out of 18mm th. approved plywood with T.W beading on edges, 12mm th. approved plywood on back with one coat of wooden primer, 1mm th.lamianta (multi colour and groves in laminates as per drawing) on all external surfaces & oil paint two coat over two coats of putty on all internal surfaces, 4" long brush finished stainless steel handles, lock, magnets for shutter and three coats of French polish to T.W beading/ T.W members. (Note:- Fiber body make can also be provided or as per directed by architect.)	No.	2.00		
30.	<b>WALL PANELING: -</b> Providing & fixing paneling over Wall or wherever required as per directed by Architect/Bank with 12mm th. plywood of approved make i.e. Century Ply (i.e. Architect Ply, Club Prime, Bond-710) or Green Ply on aluminum frame work 2" x 1" at 12"c/c on both side finished with 1mm th. Laminate of approved colour & make i.e. (Century Lam / Greenlam / Sunmica / Archid Lam). The rate shall include all necessary hardware fittings etc. The rates shall include work in multicolor laminates, grooves. All necessary hardware, tools and plants required for the work to make to the column/wall in true line & level.(Wall Paneling	Sq.Ft	420.00		

**UCO BANK**  
**Zonal Office, Nagpur**

	must be done till 3'6" ht. level from floor level or as per the direction of Bank/Architect.)				
31.	<b>MANAGER, OFFICER OR VISITORS CHAIRS:-</b> Providing and supplying medium back chairs as per following specification (1). The chairs has a back inner / outer shell made out up of polypropylene having snap type fittings. (2). Moulded foam (48 DENSITY) is used on the seat and back. (3). A hot presses plywood seat (12 MM THICK) is used as base (4). The arm rest used is made up of soft polyurethane (250 density) having mild steel insert (5).The tilting mechanism used is having only back movement lockable at the front position. (6). The seat to back connecting mild steel plate is 10 MM thick. The handle connecting mild steel plate is 5 MM thick. (7). A seat outer made up of POLYPROPYLENE is used for asthetic appeal. (8). An imported gas lift mechanism is used for seat height adjustment. (9). A mild steel powder coated base (630 MM WIDE) is used having a load capacity of 800 KGS. (10). Twin wheel nylon castore are used having a load bearing capacity of 50 Kgs. Per Caster. <b>Make as specified as Godrej Interior, Featherlite, Urban Ladder, Green Soul, CellBell, Cello, Pepperfry, Nilkamal or as per directed by Bank.</b>				
a)	AGM CHAIRS (HIGH BACK) with revolving and tilting arrangement as per above specification.	Nos.	0.00		
b)	CHIEF/BRANCH MANAGER CHAIRS (HIGH BACK) with revolving and tilting arrangement as per above specification.	Nos.	0.00		
c)	OFFICERS/STAFF CHAIR (MEDIUM BACK) with revolving and tilting arrangement as per above specification.	Nos.	0.00		
d)	VISITORS CHAIR /AGENT/ DISCUSSION ROOM CHAIRS - Specification same as above but the Chairs have Fixed back having no tilting mechanism. Only revolving facility would be available.	Nos.	0.00		
32.	<b>ALUMINUM COMPOSITE PANELING:-</b> Providing & fixing in required position 3mm th. exterior grade aluminium composite panel in ceiling & vertical cladding as directed by the architect, in front façade of column in composite panel of Metallic Exterior grade of lennox / Alto Bond / equivalent make, over a frame work made out of 50mm x 50mm x 2mm aluminum SHS anchored to existing M.S Structure including installing the composite panel in grid pattern of size 2'0"x 2'0" (app.) or of required size as directed with the help of	Sq.Ft	105.00		

**UCO BANK**  
**Zonal Office, Nagpur**

	aluminium cleats / angle of size 1"x1" and striking out the joints with weather silicon of dow corning 789 / wacker make and as directed by the banks architect. The rate shall include cutting of panels its bending cutting for providing down-lighters etc complete labour, scaffolding etc. <b>(Note: Work to be done in Outer Wall ceiling level or as directed by Architect.)</b>				
<b>33.</b>	<b>PAINTING WORK:-</b>				
<b>a.</b>	Providing and applying Luxury Emulsion of approved make on Internal & External wall surface as detailed below scrapping for surface with emery paper and wipe clean for area, wall primer with bush by adding minerals turpentine oil by 8 to 10% or water by 15 to 20% allowing drying for 6 to 8 hours. After applying Asian / Berger / Nerolac / Dulex Paints or equivalent acrylic wall putty with appropriate proportion of water of allow to dry for a period of 4 to 6 hrs.of activity. Scrapping with emery paper and wipe clean applying paints Royale Luxury Emulsion 1 <sup>st</sup> Coat with brush water content water to 40 to 45% or 65 to 70% by role. Applying paints Royale Luxury emulation 2 <sup>nd</sup> coat with brush with water content 40 to 45% or 65 to 70% by roller. <b>(Work to be done with prior approval of the Bank Authority.)</b>	<b>Sq.Ft</b>	<b>6000.00</b>		
<b>34.</b>	<b>SLOTTED ANGLE FILE RACK:</b> - Providing, Supplying & fixing Storing/Slotted Angle File Cabinet of 3'0"x1'3"x12'/10') with an angle of 35x5mm with slots in it for the rack adjustment and partition with 18 gauge thickness and by applying primer and anticorrosive oil paint completely or as per the direction of Bank/Architect or as per the requirement of site condition.	<b>Nos.</b>	<b>4.00</b>		
	<b>Total</b>				
			<b>Say</b>		
<b>In-Words: -</b>					
<b>Note: Rate put to tender will be exclusive of GST and same will be borne by the Bank Authority as per Govt.Rule.</b>					

Date:

Place: -

Seal & Signature of Tenderer

Tender –Interior Furniture & Electrical Work of Chandrapur Branch, Chandrapur, Zonal Office-Nagpur.  
**Architect: - M/s Shreyash Nandanwar & Co.**

**UCO BANK**  
**Zonal Office, Nagpur**

**Name of Work: - Quotation for Electrical Work of Chandrapur Branch, Chandrapur**  
**UCO Bank, Zonal Office, Nagpur.**

Interior Electrical Work (Part-B)					
Sr.No.	Description of Items	Qty.	Rate	Units	Amount
1	Wiring for <b>light point/ fan point/ exhaust fan point/ call bell point</b> with 1.5 sq.mm FRLS PVC insulated copper conductor single core cable in surface / recessed steel conduit, with modular switch, modular plate, suitable GI box and earthing the point with 1.5 sq.mm FRLS PVC insulated copper conductor single core cable etc. as required. (Wire Make: Legrand / Poly Cab / Havel Only.)	42.00		Point	
2	Supplying and fixing suitable size GI box with modular plate and cover in front on surface or in recess, including providing and fixing <b>1 Nos. 3 pin 5/6 A modular socket with switch outlet</b> connections etc. as required. Make : Legrand Myrius Myrius Cover plate or equivalent MDS / Salzer.( <b>Switches</b> )	7.00		Each	
3	Supplying and fixing suitable size GI box with modular plate and cover in front on surface or in recess, including providing and fixing <b>3 Nos. 3 pin 5/6 A modular socket outlet and 1 Nos.15 A modular switch</b> , connections etc. as required. Make : Legrand Myrius Myrius Cover plate or equivalent MDS / Salzer. ( <b>Switches</b> )	12.00		Each	
4	Wiring for circuit/sub main wiring along with earth wire with the <b>2×2.5 sq.mm+ 1×2.5 sq.mm</b> earth wire sizes of FRLS PVC insulated copper conductor, single core cable in surface/recessed steel conduit as required. <b>For UPS power supply 1 / 2 Board =1Circuit</b> (Wire Make: RR Kabel/ Finolex / Apar Only.)	267		Meter	
5	Supplying and fixing suitable size GI box with modular plate and cover in front on surface or in recess, including providing and fixing <b>1 Nos. 3 pin 5/6 A modular socket outlet and 1 Nos.5/6 A modular switch</b> , connections etc. as required. Make : Legrand Myrius Myrius Cover plate or equivalent MDS / Salzer.( <b>Switches</b> )	8.00		Each	
6	Wiring for circuit/sub main wiring along with earth wire with the <b>2×2.5 sq.mm+ 1×2.5 sq.mm</b> earth wire sizes of FRLS PVC insulated copper conductor, single core cable in surface/recessed steel conduit as required. <b>For lighting Circuit &amp; Raw power.</b> (Wire Make: RR Kabel/ Finolex / Apar Only.)	296		Meter	

Tender –Interior Furniture & Electrical Work of Chandrapur Branch, Chandrapur, Zonal Office-Nagpur.  
**Architect: - M/s Shreyash Nandanwar & Co.**

**UCO BANK**  
**Zonal Office, Nagpur**

7	Wiring for circuit/sub main wiring along with earth wire with the <b>2×1.5 sq.mm+ 1×1.5 sq.mm</b> earth wire sizes of FRLS PVC insulated copper conductor, single core cable in surface/recessed steel conduit as required. <b>Loop circuit for Light &amp; Raw power</b> (Wire Make: RR Kabel/ Finolex / Apar Only)	222		Rmt	
8	Supplying and fixing suitable size GI box with modular plate and cover in front on surface or in recess, including providing and fixing <b>2 Nos. 15/16 A modular socket outlet and 2no 15/16 A modular switch</b> , connections etc. as required. Make: Legrand Myrius with Cover plate or equivalent MDS / Siemens.	5.00		Each	
9	Supplying & fixing suitable size GI box with modular plate and cover in front on surface or in recess including providing and fixing <b>25 A modular socket outlet and 25 A modular SP MCB, "C" curve</b> including connections, painting etc. as required. Make: Legrand or Siemens.	7.00		Each	
10	Wiring for AC with <b>2×4 sq.mm FRLS PVC</b> insulated copper conductor single core cable in surface/recessed steel conduit along with 1 No. 4 sq. mm FRLS PVC insulated copper conductor single core cable for loop earthing as required. (Wire Make: RR Kabel/ Finolex / Apar Only.)	240.00		Rmt	
11	Providing & fixing of <b>35 sq.mm aluminum Armored Cable</b> with 10 swg GI earth wire for <b>Main Incomer</b> .	42		Rmt	
12	Providing & fixing of <b>4core 10 Sq.mm Copper armored Cable</b> with 12 swg Cu earth wire	56.00		Rmt	
13	Providing & fixing of <b>4core 6 Sq.mm copper Armored Cable</b> 12 swg Cu earth wire	24.00		Rmt	
14	Providing & fixing of <b>2 core 1.5mm copper armored Cable</b> 12 swg Cu earth wire.	114.00		Rmt	
15	Providing & fixing 4way VTPN DB including Incomer 1No. 100A MCCB 25K outgoing 3no. 63A 3 Pole MCB , 4No SP MCB	1.00		Each	
16	Providing & fixing of 8Way ETPN DB for Light & Power Incomer- 1No. 63A 4Pole MCB, outgoing - SP MCB 18 No. 2Pole DP MCB 4Nos. Etc. complete. (Legrand/Hager Make)	1.00		Each	

**UCO BANK**  
**Zonal Office, Nagpur**

17	Providing and fixing 12 way Double doors DB with 6 No.4A. to 16 A SP MCB and 25 A isolator of approved make for UPS output along with enclosure for I/P circuit.(Legrand/Hager Make)	1.00		Each	
18	Providing & fixing of 100A MCCB with Enclosure for UPS Incomer	1.00		Each	
19	Providing & fixing of 63A 4pole MCB without door water proof enclose for ATM/E-lobby	0.00		Each	
20	Supplying and fixing DP sheet steel enclosure on surface/ recess along with 63/40 A 240 V "C" curve DP MCB complete with connections, testing and commissioning etc. as required. Make: Legrand or Siemens for UPS input & output.	2.00		Each	
21	Providing & fixing of 100 amp BAS BAR for incoming supply. ( Ashok Make)	1.00		Each	
22	24 Hrs Timers with 2No. 25A Connector with DP MCB 40A - 1 Nos & 2No. Indicator for E- Lobby.	1.00		Each	
23	Providing & fixing of 15 KVAR Capacitor with 63A TP MCB with Encloser	1.00		Each	
24	Supply, installation, testing, commissioning of indoor recessed mounting 2' x 2' LED Fitting with head frame required for mounting on Gypsum or Grid ceiling(LKM2240 34W LUKER / Havells Plano REC 34 Watt MAKE only	34.00		Each	
25	Supply, installation, testing, commissioning of indoor recessed LED Down Lighter required for mounting on Gypsum or Grid ceiling(INTEIGRA NEO DLR 15W LED / Havells Plano REC 34 Watt MAKE only	28.00		Each	
26	Supply ,Installation, testing and commissioning ceiling fan with 900 mm dia,high speed motor for higher air delivery, thermal overload protector (TOP) helps in protecting the motor in case of any high voltage fluctuation etc. (Make : 5* Star Rating Crompton Allsthom / Havells.)	3.00		Each	
27	Supply ,Installation, testing and commissioning ceiling fan with 1200 mm dia,high speed motor for higher air delivery, thermal overload protector (TOP) helps in protecting the motor in case of any high voltage fluctuation etc. (Make: 5* Star Rating Crompton Allsthom / Havells.)	7.00		Each	



**UCO BANK**  
**Zonal Office, Nagpur**

28	Supplying and fixing two module stepped type <b>electronic fan regulator</b> on the existing modular plate switch box including connections but excluding modular plate etc. as required. Make : Legrand Myrius with Cover plate or equivalent MDS / Siemens.	10.00		Each	
29	<b>Supply ,Installation, testing and commissioning</b> of pre-wired, fluorescent fitting compact fluorescent fitting / 1x18W <b>LED</b> of all types, complete with all accessories and tube/lamp etc. directly on ceiling/ wall, including connections with 1.5 sq. mm FRLS PVC insulated, copper conductor, single core cable and earthing etc. as required.	10.00		Each	
30	<b>Supply ,Installation, testing and commissioning exhaust fan</b> A.C 230 V. of 300mm. Air delivery 20CMM, 50 Watts, 1400 RPM, Dynamically balanced blades for vibration free rotation, aluminium die-cast body to ensure long life and all accessories etc. <b>(Note:- 2nos. in Toilet &amp; 1nos. in UPS/Battery Room)</b>	3.00		Each	
31	Supplying and fixing high speed wall mounted fan of 16" dia or as directed by Architect/Bank (Crompton make )	3.00		Each	
32	<b>Supplying and fixing of outdoor louvers/shutters.</b> Providing louvers/ shutters of size 300mm made up of GI sheet of size 0.8mm thick, and required frame, necessary arrangement for lifting of louvers.	1.00		Each	
	<b>EARTHING :-</b>				
33	Providing earthing by using 600mmx600mm x3 mm thick copper plate buried in specifically prepared earth pit 2.4m below ground with 50kg. Charcoal and salt with 19mm. Dia. G.I.pipe with funnel with a wire mesh for watering and brick masonry block C.I.cover complete as Para 7.3 of IS 3043-1966 with necessary length of 8 No. double copper earth wire bolted with lug to the plate and covered in 15mm Dia GI pipe 2.5 mtr. long complete connected to the nearest switch gear with end socket as per direction and duly tested by the earth tester.	1.00		Each	

**UCO BANK**  
**Zonal Office, Nagpur**

34	Providing & laying of 1 nos. of 25mm x 3 mm thick Copper. earthing strip for the earthing requirements for New Panel. Note: - The contractor is to lay 1 no. of the above mentioned G.I.earthing strips. The quantity given alongside is the total quantity.	21.00		Rmt	
35	Providing earthing by using 600mmx600mm x3 mm thick GI plate buried in specifically prepared earth pit 2.4m below ground with 50kg. Charcoal and salt with 19mm. Dia. G.I.pipe with funnel with a wire mesh for watering and brick masonry block C.I.cover complete as Para 7.3 of IS 3043-1966 with necessary length of 8 No. double copper earth wire bolted with lug to the plate and covered in 15mm Dia GI pipe 2.5 mtr. long complete connected to the nearest switch gear with end socket as per direction and duly tested by the earth tester.	1.00		Each	
36	Providing & laying of 1 nos. of 25mm x 3 mm thick G.I.earthing strip for the earthing requirements for New Panel. (Note: - The contractor is to lay 1 no. of the above mentioned G.I.earthing strips.) The quantity given alongside is the total quantity.	23.00		Rmt	
37	Providing and laying of Cat-6 Data cable D- Link Make	312.00		Rmt	
38	Providing & fixing of 24 ports Patch Panel D Link Make.	1.00		Each	
39	Providing & fixing of 9 U Rack D Link Make	1.00		Each	
40	Providing & fixing of Cat 6 Patch Cords 1Mtr	12.00		Each	
41	Providing & fixing of Cat 6 Patch Cords 2Mtr	12.00		Each	
42	Providing & fixing of 24 ports Networking Switch. D link Make 10 x 100 x 1000	1.00		Each	
43	Providing & fixing of IO Box with Plate	7.00		Each	
44	Providing & fixing of telephone point with 2Pair Cable .5mm from EPABX, Anchor Make including PVC Pipe, RJ 11 Modular Socket & Plate etc .	8.00		Each	
45	Supply, installation, testing commissioning of 2 pair telephone cabling.	240.00		Rmt	
46	Providing & fixing of 6 sqmm x 2 wires + 4 sqmm x 1 wire for UPS O/P (Loose wire in flexible PVC pipe from UPS to I/P & O/P 2pole DB (Polycab/Havels make).	15.00		Rmt	
47	Providing and fixing circuit wiring from Inverter to Lighting Switch Board.	132.00		Rmt	
( B )	AC WORK :-				

**UCO BANK**  
**Zonal Office, Nagpur**

1	Supply & erecting HI wall Mounted split Air Conditioner <b>2.0 Tr 5/3 Star</b> Rating with copper piping & Inverter completed of approved make Voltas /Panasonic / Daikin / O-General ( <b>Note</b> :- Rate Including Unit as well as fitting & fixtures like Bracket, copper Pipe ,Drain Pipe & copper wiring etc Completed ) <b>(Used in Banking Hall Area)</b>	3.00		Each	
2	Supply & erecting HI wall Mounted split Air Conditioner <b>1.5 Tr 5/3Star</b> Rating with copper piping & inverter completed of approved make Voltas /Panasonic / Daikin / O-General ( <b>Note</b> :- Rate Including Unit as well as fitting & fixtures like Bracket, copper Pipe ,Drain Pipe & copper wiring etc Completed.) <b>(Used in Manager Cabin Area Only.)</b>	0.00		Each	
3	Supply & erecting HI wall Mounted split Air Conditioner <b>1.0 Tr 5/3Star</b> Rating with copper piping & Inverter completed of approved make Voltas /Panasonic / Daikin / O-General ( <b>Note</b> :- Rate Including Unit as well as fitting & fixtures like Bracket, copper Pipe ,Drain Pipe & copper wiring etc Completed ) <b>(Used in ATM Area Only).</b>	1.00		Each	
3	Providing & fixing of extra copper piping for AC. (Note :- If required as per Site situation other than items received with the unit itself)	60.00		Rmt.	
4	Providing & fixing of 2.5 sq mm x 4 core copper cable for indoor and outdoor unit.	66.00		Rmt.	
5	Providing & fixing of drain piping of AC with concealed zari and plastering etc. complete.	72.00		Rmt.	
	Sub-Total	(A) Rs.			
In-Words:-					

**U C O   B A N K**  
**Z o n a l   O f f i c e ,   N a g p u r**

**ABSTRACT ESTIMATE**

Sr.N	Description	Part	Cost in Rupees
1	Interior Work	(A)	
2	Electrification Work	(B)	
		Total Rs.	
Note: - The Rate and total amount put to tender is excluding GST and will be applicable as per Govt.Rule. Same will be Borne by the Bank Authority.			

In-Words: -

Date:

Place: -

Seal & Signature of Tenderer

# UCO BANK

## Zonal Office, Nagpur

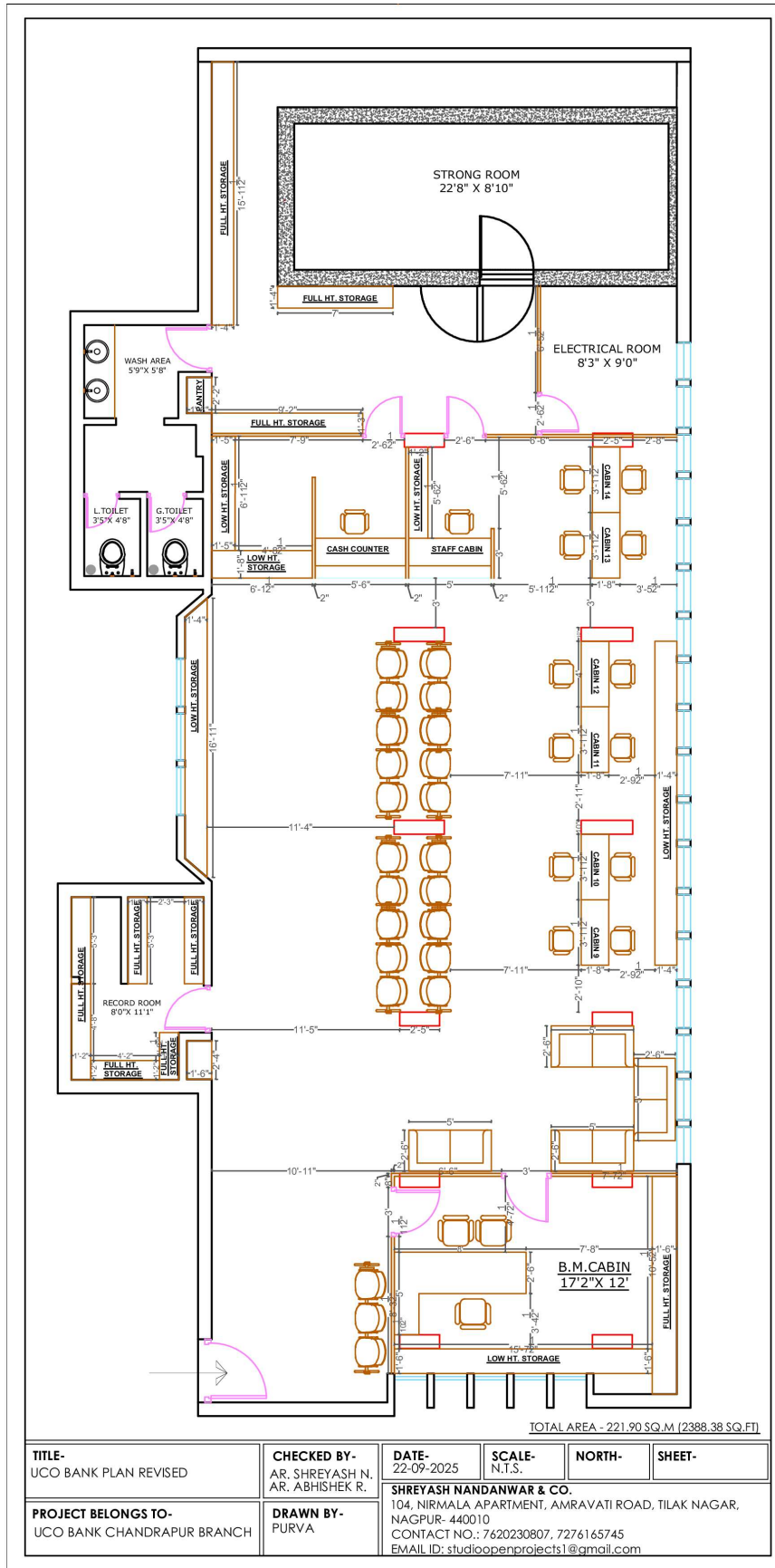

Tender –Interior Furniture & Electrical Work of Chandrapur Branch, Chandrapur, Zonal Office-Nagpur.  
**Architect: - M/s Shreyash Nandanwar & Co.**

# UCO BANK

## Zonal Office, Nagpur

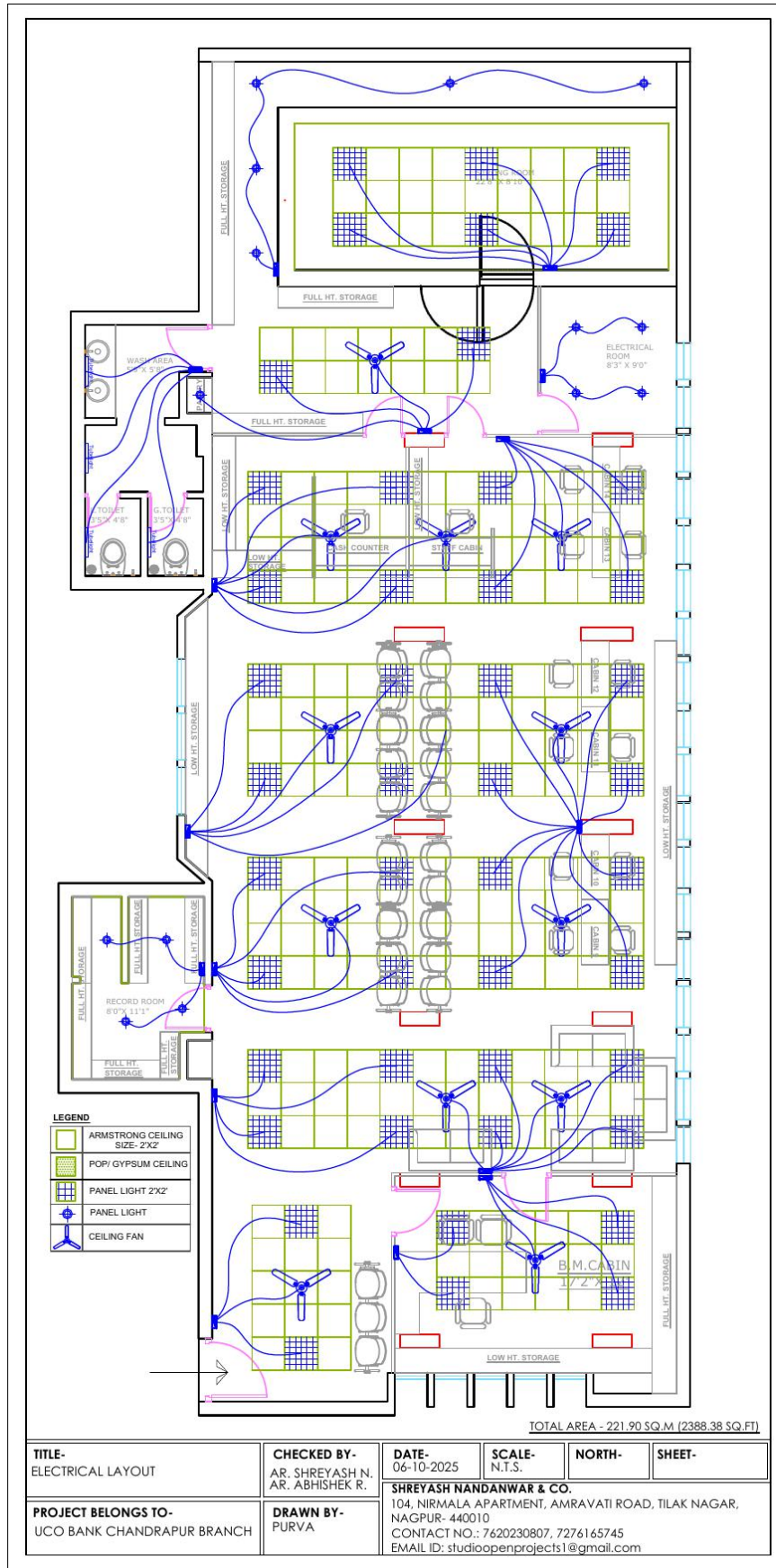

Tender –Interior Furniture & Electrical Work of Chandrapur Branch, Chandrapur, Zonal Office-Nagpur.  
**Architect: - M/s Shreyash Nandanwar & Co.**

# UCO BANK

## Zonal Office, Nagpur

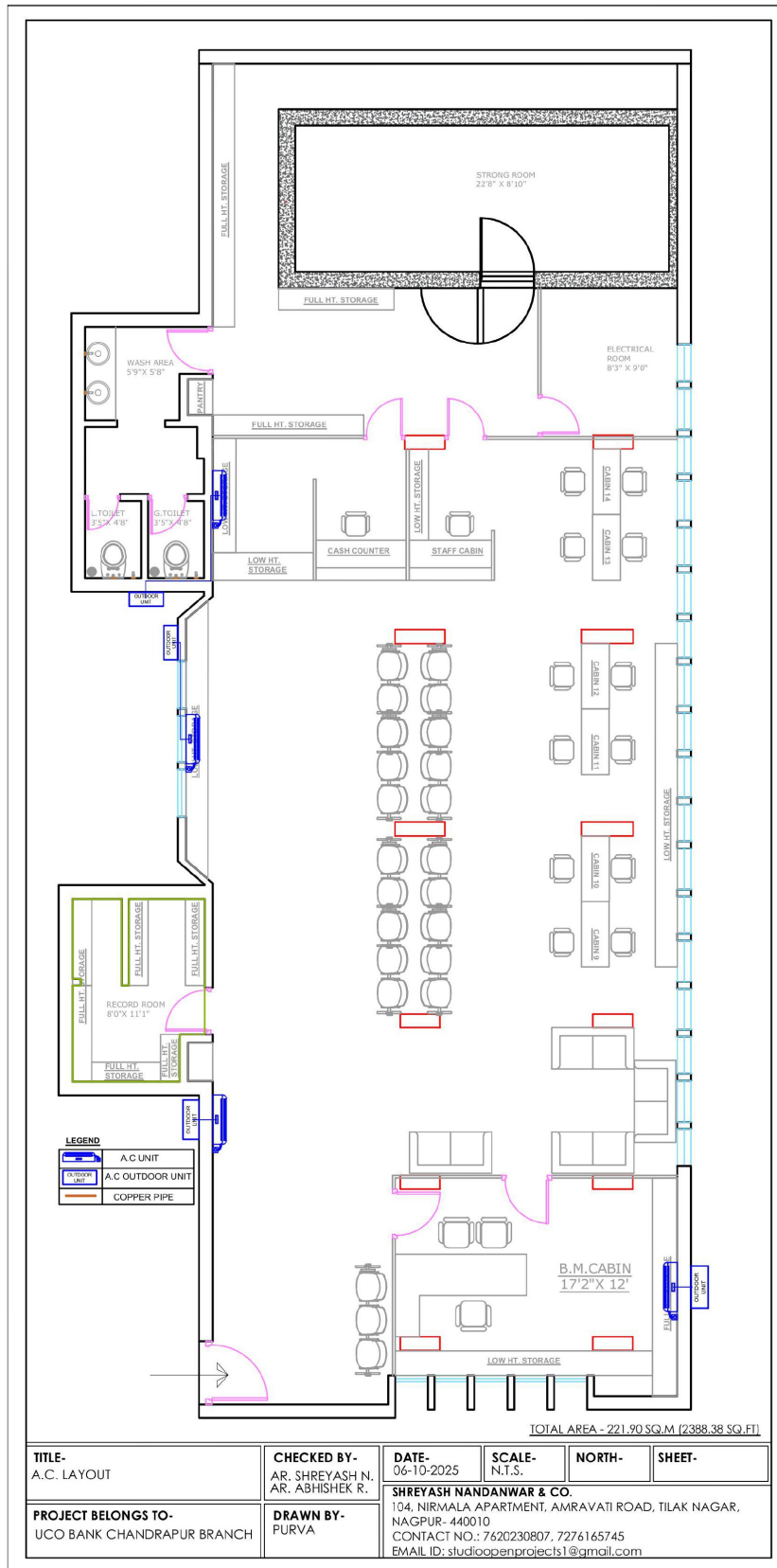

Tender –Interior Furniture & Electrical Work of Chandrapur Branch, Chandrapur, Zonal Office-Nagpur.  
**Architect: - M/s Shreyash Nandanwar & Co.**

# UCO BANK

## Zonal Office, Nagpur

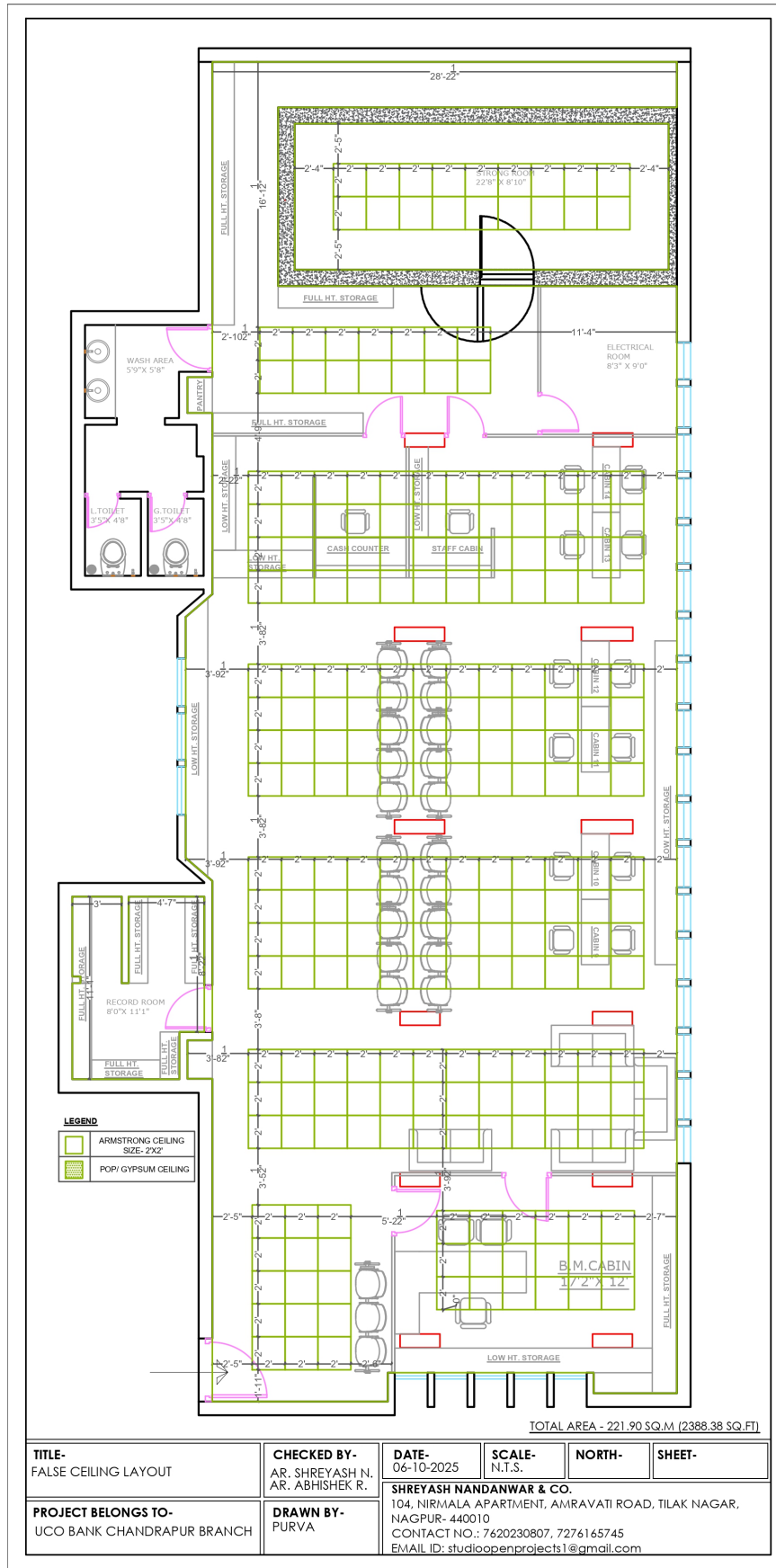

Tender –Interior Furniture & Electrical Work of Chandrapur Branch, Chandrapur, Zonal Office-Nagpur.  
**Architect: - M/s Shreyash Nandanwar & Co.**